

CITY OF LAMONT COUNTY OF KERN STATE OF CALIFORNIA
SIDEWALK CONSTRUCTION PLAN
BEAR MOUNTAIN RECREATION

GRADING NOTES

- ALL WORK SHALL BE DONE IN CONFORMANCE WITH THE COUNTY OF KERN STANDARDS AND SHALL CONFORM TO THE RECOMMENDATIONS CONTAINED AND MADE A PART HEREOF IN THE PRELIMINARY SOILS REPORTS BY: _____ DATED: _____ AND SIGNED BY: _____
- CONTRACTOR SHALL OBTAIN ALL NECESSARY PERMITS REQUIRED BY THE COUNTY OF KERN.
- THE ENGINEER HAS SHOWN EXISTING UNDERGROUND LINES ON THIS PLAN TO THE BEST OF HER KNOWLEDGE. THERE MAY BE OTHER LINES IN THE GROUND. IT SHALL BE THE CONTRACTOR'S RESPONSIBILITY TO VERIFY LINES IN THE FIELD PRIOR TO ANY CONSTRUCTION. THE CONTRACTOR SHALL CONTACT U.S.A. (1-800-642-2444) FOR UTILITY LOCATION 48 HOURS PRIOR TO ANY EXCAVATION OR TRENCHING.
- CONTRACTOR AGREES THAT HE SHALL ASSUME SOLE AND COMPLETE RESPONSIBILITY FOR JOB SITE CONDITIONS DURING THE COURSE OF CONSTRUCTION OF THIS PROJECT, INCLUDING SAFETY OF ALL PERSONS AND PROPERTY; THAT THIS REQUIREMENT SHALL APPLY CONTINUOUSLY AND NOT BE LIMITED TO NORMAL WORKING HOURS; AND THAT THE CONTRACTOR SHALL DEFEND, INDEMNIFY AND HOLD THE OWNER AND THE ENGINEER HARMLESS FROM ANY AND ALL LIABILITY, REAL OR ALLEGED, IN CONNECTION WITH THE PERFORMANCE OF WORK ON THIS PROJECT, EXCEPTING FOR LIABILITY ARISING FROM THE SOLE NEGLIGENCE OF THE OWNER OR THE ENGINEER.
- ALL EXISTING IMPROVEMENTS THAT ARE REMOVED, DAMAGED OR UNDERCUT SHALL BE REPAIRED OR REPLACED AS DIRECTED BY THE COUNTY ENGINEER, AT THE CONTRACTOR'S EXPENSE.
- THE CONTRACTOR SHALL NOTIFY THE ENGINEER AND THE COUNTY'S BUILDING OFFICIAL 48 HOURS PRIOR TO PLACING OF ANY FILL MATERIAL.
- COMPACTION TESTS SHALL BE PROVIDED BY THE CONTRACTOR AT LOCATIONS TO BE DETERMINED BY THE COUNTY INSPECTORS.
- FILL MATERIAL SHALL BE SUBJECT TO THE APPROVAL OF THE SOILS ENGINEER.
- THE CONTRACTOR SHALL BE RESPONSIBLE FOR GRADING OF PAD AREA WITHIN ± 0.1' IF ELEVATION OF DESIGN ELEVATION PAD SHOULD BE FOUND TO BE MORE THAN ± 0.1' OFF OF DESIGN ELEVATION AFTER COMPLETION AND ACCEPTANCE OF GRADING, THE CONTRACTOR SHALL RETURN AND CORRECT THE GRADING AT NO COST TO THE OWNER.
- CONTRACTOR SHALL TERRACE ALL PADS WHEN ELEVATION DIFFERENCE BETWEEN PADS IS GREATER THAN 0.3' UNLESS OTHERWISE SHOWN.
- ALL AREAS ON THE SITE ON WHICH STRUCTURES ARE TO BE PLACED MUST BE COMPACTED TO 90% DENSITY, FOR A MINIMUM DISTANCE OF 5' IN ALL DIRECTIONS FROM THE FOUNDATIONS OF THE STRUCTURE. ON RESIDENTIAL LOTS, THE REQUIRED AREA OF COMPACTION IS BOUNDED BY THE PAD LIMIT LINE, SIDE LOT LINES AND WITHIN 10' OF THE REAR LOTLINE.
- ALL FILL SHALL CONFORM TO THE REQUIREMENTS FOR "ENGINEERED FILL" AS DESCRIBED IN THE PRELIMINARY SOILS REPORT.
- FILL MATERIAL SHALL BE PLACED IN LAYERS NOT EXCEEDING SIX (6) INCHES IN COMPACTED THICKNESS AND COMPACTED AT OPTIMUM MOISTURE CONTENT BY AN APPROVED METHOD.
- THE DESIGN ENGINEER SHALL EXERCISE SUFFICIENT SUPERVISORY CONTROL DURING GRADING AND CONSTRUCTION TO INSURE COMPLIANCE WITH THE PLANS, SPECIFICATIONS, AND CODE WITHIN HIS PURVIEW.
- COMPACTION IN PROPOSED PAVEMENT AREAS SHOULD BE TO A MINIMUM OF 95% OF THE MAXIMUM DENSITY AS OBTAINED BY A.S.T.M. TEST METHOD D1557-78, METHOD A, AND SHOULD EXTEND TO A MINIMUM DISTANCE OF 2' BEYOND THE OUTSIDE EDGES OF PAVEMENTS.
- UPON COMPLETION OF GRADING AND BEFORE THE START OF CONSTRUCTION, A FINAL SOILS REPORT COVERING THE SITE PREPARATION AND GRADING SHALL BE SUBMITTED BY THE SOILS ENGINEER.
- ALL GRADING SHALL CONFORM WITH CHAPTER 70 UNIFORM BUILDING CODE AND STANDARDS PERTAINING THERETO.
- ALL CUT SLOPES SHALL NOT BE STEEPER THAN 2 HORIZONTAL TO 1 VERTICAL.
- ALL FILL SLOPES SHALL NOT BE STEEPER THAN 2 HORIZONTAL TO 1 VERTICAL.
- ALL FILL AREAS SHALL BE CLEARED OF ALL VEGETATION AND OTHER UNSUITABLE MATERIAL FOR A STRUCTURAL FILL AND THE AREA SCARIFIED TO A DEPTH OF 12".
- ALL SLOPES IN EXCESS OF 3' IN VERTICAL HEIGHT SHALL BE PREPARED AND MAINTAINED TO CONTROL AGAINST EROSION.
- SURFACE DRAINAGE SHALL BE 1% MINIMUM EXCEPT AS WAIVED BY BUILDING OFFICIAL.
- GRADING WORK WILL BE SUPERVISED AS ENGINEERED GRADING IN ACCORDANCE WITH CHAPTER 70 OF UNIFORM BUILDING CODE.
- ALL CUT AND FILL SLOPES GREATER THAN 3.0' HIGH SHALL BE HYDRAULICALLY PLANTED (HYDROSEEDING) IN A UNIFORM MANNER. TYPE OF SEED SHALL BE APPROVED BY THE CITY BUILDING DEPARTMENT.
- DEWALT CORPORATION SHALL NOT BE RESPONSIBLE OR LIABLE FOR UNAUTHORIZED CHANGES TO, OR USES OF, THESE PLANS. ALL CHANGES TO THESE PLANS MUST BE APPROVED IN WRITING BY DEWALT CORPORATION.
- DUST CONTROL:
IT SHALL BE THE CONTRACTOR'S RESPONSIBILITY TO PREVENT A DUST NUISANCE FROM ORIGINATING FROM THE SITE OF WORK AS A RESULT OF HIS OPERATIONS DURING THE EFFECTIVE PERIOD OF THIS CONTRACT. PREVENTATIVE MEASURES TO BE TAKEN BY THE CONTRACTOR SHALL INCLUDE, BUT NOT BE LIMITED TO, THE FOLLOWING:
A. WATER SHALL BE APPLIED TO ALL UNPAVED AREAS AS REQUIRED TO PREVENT THE SURFACES FROM BECOMING DRY ENOUGH TO PERMIT DUST FORMATION.
B. PAVED SURFACES OVER WHICH VEHICULAR TRAFFIC IS PERMITTED TO TRAVEL SHALL BE KEPT FREE OF DIRT.

GRADING NOTES CONTINUED:

- THE ENGINEER IS NOT CONTRACTED WITH THE OWNER TO PROVIDE SLOPE STAKING. IF THE CONTRACTOR WANTS THE ENGINEER TO PROVIDE SLOPE STAKING, HE SHALL HIRE THE ENGINEER TO PERFORM THIS SERVICE AT THE CONTRACTOR'S EXPENSE.
- ENGINEERED FILL SHALL BE PLACED IN ACCORDANCE WITH THE REQUIREMENTS OF THE PRELIMINARY SOILS REPORT PREPARED BY: _____ DATED: _____ AND MUST BE COMPACTED TO 90% MAXIMUM RELATIVE DENSITY.
- IF THE GRADING CONTRACTOR IS PROVIDING A BALANCED EARTHWORK PROJECT, IF THE CONTRACTOR DURING THE PROCESS OF CONSTRUCTION, FINDS HE HAS A DEFICIENCY OR EXCESS OF SOIL, HE SHALL IMMEDIATELY CONTACT THE ENGINEER, AND THE FOLLOWING MEASURES SHALL BE IMPLEMENTED AT THE DIRECTION OF THE ENGINEER:
DEFICIENCY: CONTRACTOR SHALL IMMEDIATELY CONTACT THE ENGINEER TO SEE IF STREETS AND PADS CAN BE LOWERED TO OFF SET THE DEFICIENCY AND IF NECESSARY THE CONTRACTOR SHALL IMPORT MATERIAL SUFFICIENT TO CONSTRUCT THE SITE TO THE ELEVATIONS SHOWN ON THE APPROVED CONSTRUCTION PLANS.
EXCESS: ANY EXCESS MATERIAL SHALL BE SPREAD EVENLY OVER THE PAD AREAS AT THE DIRECTION OF THE ENGINEER.
NO ADDITIONAL COMPENSATION WILL BE MADE FOR THE WORK AS DESCRIBED ABOVE.
- IF, DURING DEVELOPMENT ACTIVITIES, ANY WELL(S) ARE ENCOUNTERED THAT WERE NOT PART OF THE INITIAL REVIEW, THE PROPERTY OWNER IS EXPECTED TO IMMEDIATELY NOTIFY THE DEPARTMENT OF CONSERVATION/GEOLGIC ENERGY MANAGEMENT DIVISION'S CONSTRUCTION SITE WELL REVIEW ENGINEER IN THE INLAND DISTRICT OFFICE, AND FILE FOR DIVISION REVIEW AN AMENDED SITE PLAN WITH WELL CASING DIAGRAMS. THE DISTRICT OFFICE WILL SEND A FOLLOW-UP WELL EVALUATION LETTER TO THE PROPERTY OWNER AND LOCAL PERMITTING AGENCY.
- IF ANY PREVIOUSLY UNKNOWN ARCHAEOLOGICAL OR CULTURAL RESOURCES ARE DISCOVERED, WORK IN THE AREA OF DISCOVERY SHALL BE STOPPED AND A QUALIFIED ARCHAEOLOGIST CONTACTED TO EVALUATE THE FIND. A COPY OF THE ARCHAEOLOGIST'S EVALUATION SHALL BE SUBMITTED TO THE KERN COUNTY PLANNING AND NATURAL RESOURCES DEPARTMENT UPON ITS ISSUANCE AND ANY MEASURES RECOMMENDED BY THE ARCHAEOLOGIST SHALL BE IMPLEMENTED PRIOR TO RESUMPTION OF WORK IN THE AREA OF DISCOVERY.
- IF HUMAN REMAINS ARE DISCOVERED AT ANY TIME ON THIS PROPERTY, WORK MUST HALT IN THE AREA OF THE FIND, AND THE KERN COUNTY CORONER MUST BE NOTIFIED IMMEDIATELY (HEALTH AND SAFETY CODE SECTION 7050.5). THE KERN COUNTY PLANNING AND NATURAL RESOURCES DEPARTMENT SHALL BE NOTIFIED IMMEDIATELY FOLLOWING CORONER NOTIFICATION.

GRADING NOTES CONTINUED:

- IF ANY ABANDONED WATER WELL(S) ARE LOCATED WITHIN THE DEVELOPMENT OR DISCOVERED DURING EXCAVATION OR GRADING, THE KERN COUNTY PUBLIC HEALTH SERVICES DEPARTMENT/ENVIRONMENTAL HEALTH DIVISION MUST BE CONTACTED TO OBTAIN INFORMATION FOR THE PROPER PERMITTING AND AND DESTRUCTION PROCEDURES.
- DURING GRADING OPERATIONS, THE APPLICANT FOR A DEVELOPMENT PERMIT SHALL BE RESPONSIBLE FOR THE APPLICATION OF WATER TO DEVELOPMENT SITES TO MITIGATE THE IMPACT OF DUST AND PM10 (PARTICULATE) EMISSIONS. SPRAYING SHOULD BE SUFFICIENT TO ENSURE THAT SOILS REMAIN DAMP, WITH THE FREQUENCY OF SPRAYING DEPENDENT ON WEATHER CONDITIONS. VERIFICATION OF COMPLIANCE WILL BE THE RESPONSIBILITY OF THE KERN COUNTY PUBLIC WORKS DEPARTMENT/BUILDING INSPECTION DIVISION.
- DURING GRADING OPERATIONS, ALL ACTIVITY SHALL BE RESTRICTED TO PERIODS OF LOW WIND TO REDUCE DUST EMISSIONS. VERIFICATION OF COMPLIANCE WITH THIS MITIGATION MEASURE WILL BE THE RESPONSIBILITY OF THE KERN COUNTY PUBLIC WORKS DEPARTMENT/BUILDING INSPECTION DIVISION.
- CONSTRUCTION SPEED LIMITS WILL BE POSTED AT FIFTEEN MILES PER HOUR (15 MPH). VERIFICATION OF COMPLIANCE WILL BE THE RESPONSIBILITY OF THE KERN COUNTY PUBLIC WORKS DEPARTMENT/BUILDING INSPECTION DIVISION.
- IT IS UNLAWFUL FOR ANY PERSON TO DO, OR CAUSE TO BE DONE, ANY OF THE FOLLOWING ACTS WITHIN THE UNINCORPORATED AREAS OF THE COUNTY:
TO CREATE NOISE FROM CONSTRUCTION, BETWEEN THE HOURS OF NINE (9:00) P.M. AND SIX (6:00) A.M. ON WEEKDAYS AND NINE (9:00) P.M. AND EIGHT (8:00) A.M. ON WEEKENDS, WHICH IS AUDIBLE TO A PERSON WITH AVERAGE HEARING FACILITIES OR CAPACITY AT A DISTANCE OF ONE HUNDRED FIFTY (150) FEET FROM THE CONSTRUCTION SITE, IF THE CONSTRUCTION SITE IS WITHIN ONE THOUSAND (1,000) FEET OF AN OCCUPIED RESIDENTIAL DWELLING EXCEPT WHERE THE DIRECTOR OF THE PLANNING AND NATURAL RESOURCES DEPARTMENT OR HIS/HER DESIGNATED REPRESENTATIVE MAY FOR GOOD CAUSE EXEMPT SOME CONSTRUCTION WORK FOR A LIMITED TIME.
BEFORE ANY DIGGING OR EXCAVATION OCCURS, PLEASE CONTACT UNDERGROUND SERVICE ALERT (USA) BY DIALING 811 A MINIMUM OF TWO (2) WORKING DAYS PRIOR TO COMMENCING ANY WORK. THIS FREE AND INDEPENDENT SERVICE WILL ENSURE THAT ALL EXISTING UNDERGROUND UTILITIES ARE IDENTIFIED AND MARKED ON-SITE.

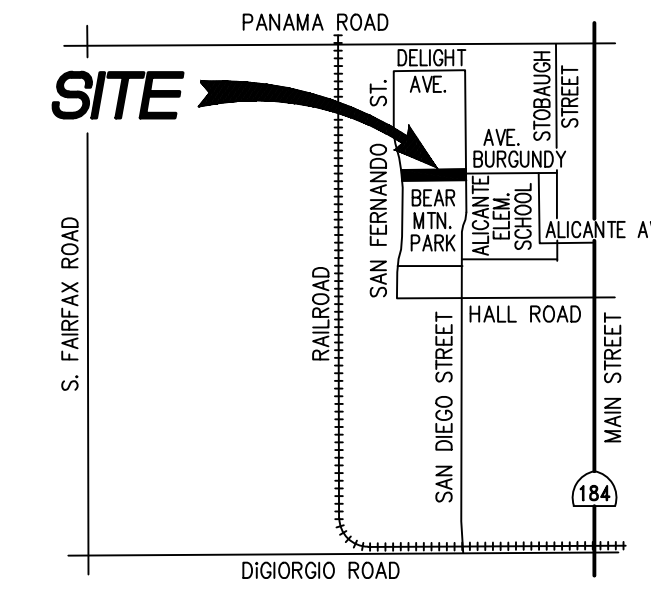

VICINITY MAP

OWNER/SUBDIVIDER

CITY OF LAMONT
P.O. BOX 658
LAMONT, CA. 93241
(661)-845-0757

ENGINEER

DEWALT CORPORATION
1930 22nd STREET
BAKERSFIELD, CA.
93301

BENCH MARK USED:

USGS BRASS DISK MONUMENT PID FU3440 WITH ELEVATION OF 396.00 SECOND ORDER.

SIDEWALK QUANTITIES

6' WIDE, 4" THICK SIDEWALK 635 L.F. 3,810 S.F.

ESTIMATED EARTHWORK QUANTITIES

	CUT	FILL
SITE GRADING	75 C.Y.	0 C.Y.

THE CUT AND FILL QUANTITIES SHOWN ON THIS PLAN ARE FOR PERMIT PURPOSES ONLY. THE CONTRACTOR SHALL, AFTER EXAMINING THE PLAN, SOILS REPORT AND THE SITE TERRAIN, PREPARE HIS ESTIMATED EARTHWORK INDEPENDENTLY OF THE ENGINEER'S.

SHEET INDEX

- TITLE SHEET/GENERAL NOTES
- SIDEWALK PLAN & PROFILE

ASSESSOR'S PARCEL NUMBER

186-020-20

PRIVATE ENGINEER'S NOTICE TO CONTRACTORS

THE EXISTENCE AND LOCATION OF ANY UNDERGROUND UTILITY PIPES OR STRUCTURES SHOWN ON THESE PLANS ARE OBTAINED BY A SEARCH OF THE AVAILABLE RECORDS. TO THE BEST OF OUR KNOWLEDGE THERE ARE NO EXISTING UTILITIES EXCEPT AS SHOWN ON THIS MAP.

THE CONTRACTOR IS REQUIRED TO TAKE DUE PRECAUTIONARY MEASURES TO PROTECT THE UTILITY LINES SHOWN AND ANY OTHER LINES NOT OF RECORD OR NOT SHOWN IN THIS DRAWING.

ENGINEER SHALL NOT BE RESPONSIBLE FOR THE ACCURACY OR COMPLETENESS OF ANY SUCH INFORMATION OR DATA.

UNDERGROUND SERVICE ALERT SHALL BE CONTACTED TWO WORKING DAYS PRIOR TO CONSTRUCTION. 1-800-642-2444

ENGINEER'S STATEMENT

THESE PLANS AND SPECIFICATIONS WERE PREPARED BY ME OR UNDER MY DIRECTION AND TO THE BEST OF MY KNOWLEDGE AND BELIEF COMPLY WITH COUNTY OF KERN ORDINANCES, STANDARDS, AND DESIGN CRITERIA, AND INCLUDE ALL IMPROVEMENT REQUIREMENTS OF THE ADVISORY AGENCY OR OTHER REVIEW BOARD.

ANY ERRORS, OMISSIONS, OR OTHER VIOLATIONS OF THOSE ORDINANCES, STANDARDS OR DESIGN CRITERIA ENCOUNTERED DURING CONSTRUCTION SHALL BE CORRECTED AND SUCH CORRECTIONS REFLECTED ON CORRECTED PLANS SUBMITTED TO THE COUNTY ENGINEER.

Michael Todd Wood
MICHAEL TODD WOOD R.C.E. 64410 EXP. 6/30/25 03-05-2024 DATE

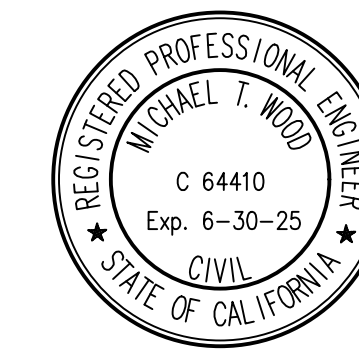

CITY OF LAMONT
BEAR MOUNTAIN RECREATION
NORTHERN SIDEWALK PLAN
COVER SHEET

1930 22nd STREET BAKERSFIELD, CA. 93301
P.H. (805) 323-4600 FAX (805) 323-4674



REVISIONS	DATE

DRAWN BY: R. BROWN	CHECKED BY: J.M.	T.W.
APPROVED BY: _____	DATE: 2/5/24	JOB NO: 24-004
ROAD FILE: 24-004	North 01	

SHEET
1
OF: 2

1030 22nd STREET, BAKERSFIELD, CA 93301
 PH: (661) 323-4600 FAX (661) 323-4674

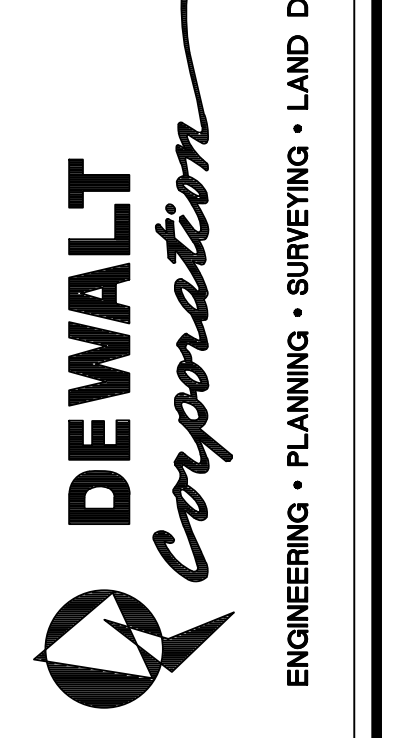

DATE	REVISIONS

DRAWN BY:	R. Bolow
CHECKED BY:	JM
APPROVED BY:	TW
DATE:	2/5/24
JOB NO.:	24-004
ACAD FILE:	24-004 Bgse

GENERLINE CURVE DATA

C1	C2	C3
$\Delta = 12^{\circ}58'42''$	$\Delta = 08^{\circ}45'51''$	$\Delta = 08^{\circ}53'54''$
$R = 100.00'$	$R = 100.00'$	$R = 100.00'$
$T = 11.37'$	$T = 7.66'$	$T = 7.78'$
$L = 22.65'$	$L = 15.30'$	$L = 15.53'$

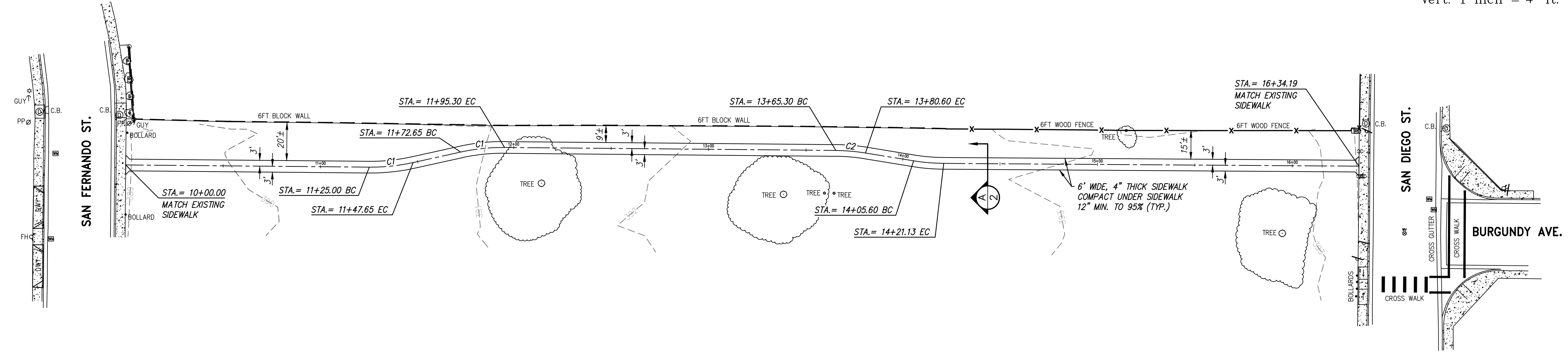
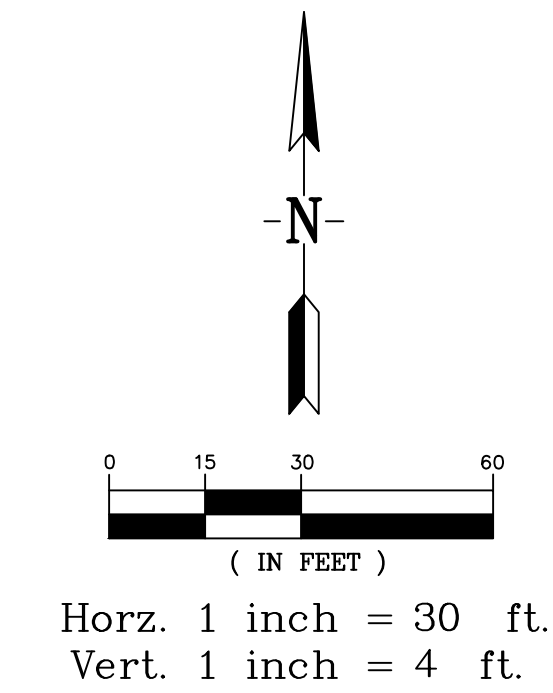
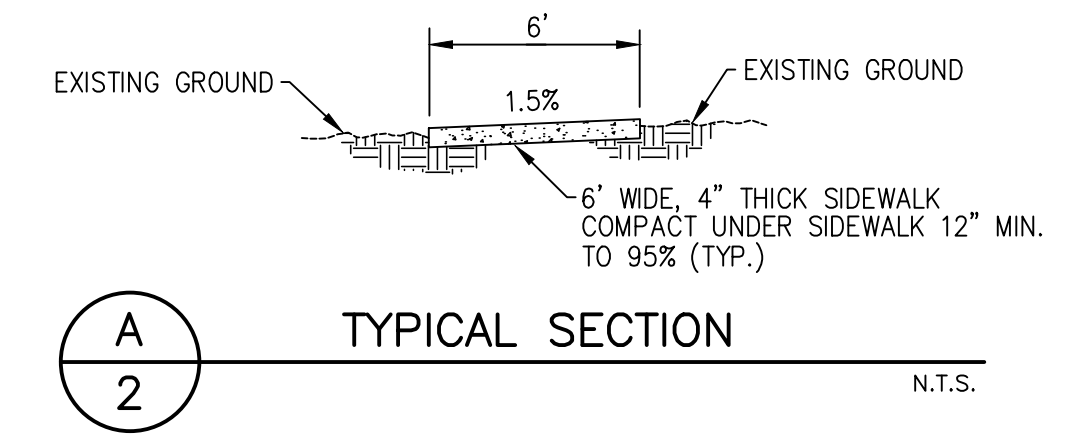

NORTHERN SIDEWALK

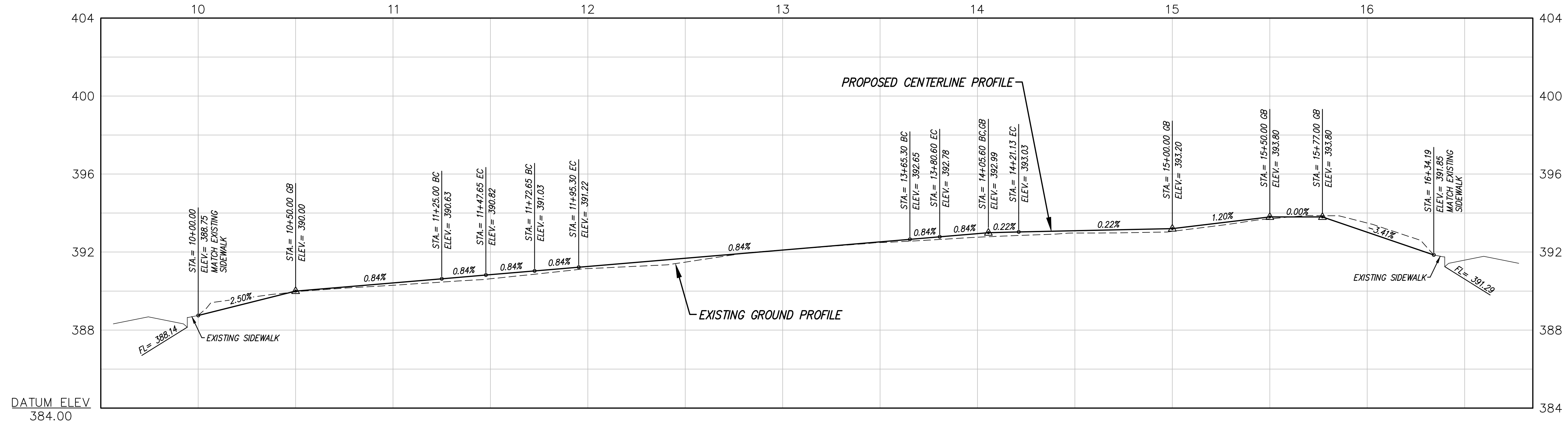

DATUM ELEV
 384.00